

M LEVEL



Levelo

**SkyInk 2 in 1 Stylus Pen
& Ballpoint Pen For iPad & Writing**

SKU: LVLSI21PBWH

Table of Contents

Features	2
Schematic View	3
Compatibility	3
Instructions for Use	3
Dimensions	5
Light Indicator Guide	5
Specifications	6
Warranty	7
Contact us	7

Before installing and using the product, please carefully read this User Manual to guarantee correct usage and keep it secure for future reference.

Features

1. The ballpoint nib is suitable for free-hand writing.
2. Engineered to quickly and efficiently power up devices.
3. Offers precise control and enables natural shading up to 90°.
4. Automatically powers down after a period of inactivity, thereby conserving energy.
5. The palm rejection feature prevents unintentional marks or commands caused by the hand resting on the screen.

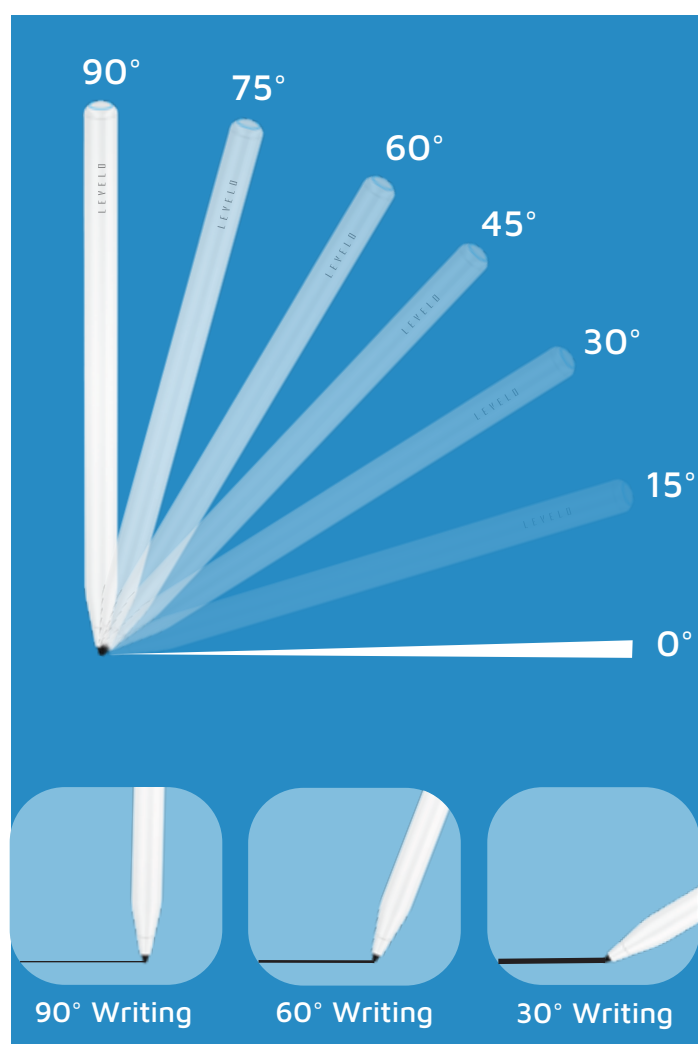



Schematic View

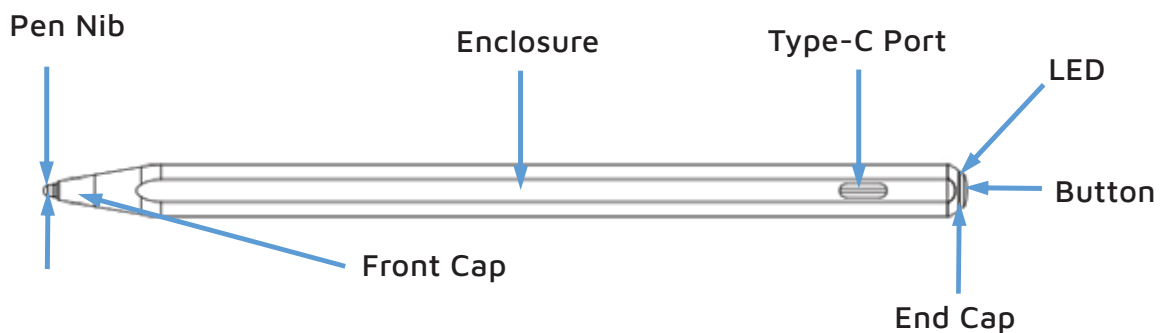

Compatibility

1. iPad Pro 12" ,12.9" , and 11" (7th to 3rd Generation)

Note: Does not support magnetic absorption on iPad Pro 2024.

2. iPad Air 13" and 11"/10.9" (6th to 4th Generation)

3. iPad (9th to 6th Generation)

4. iPad Mini (6th and 5th Generation)

Instructions for Use

The Levelo SkyInk Stylus Pen is a versatile device designed for iPads that functions both as a smart and a conventional pen. When used as an electrostatic pen, the nib is made of conductive plastic to interact seamlessly with the iPad's screen. As a standard ballpoint pen, the nib is crafted from metal, suitable for writing on paper. The two nibs, one plastic and one metal, can be easily interchanged. To switch the nibs, simply push the current nib to eject it and replace it with the other. Once inserted, press the new nib to secure it in place.

The pen is equipped with the 'Stylus Pen Nib'.

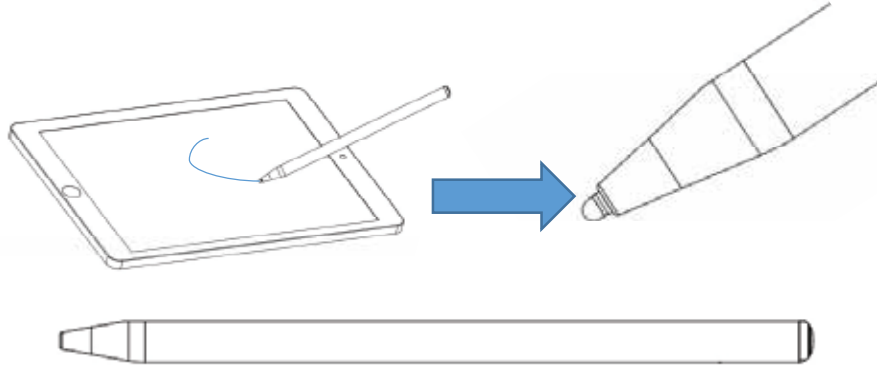

Ejecting the pen nib.

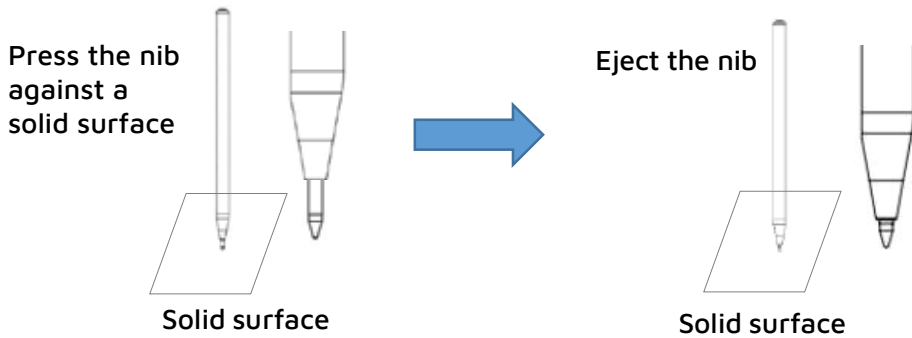

Pull out the current nib and replace it.

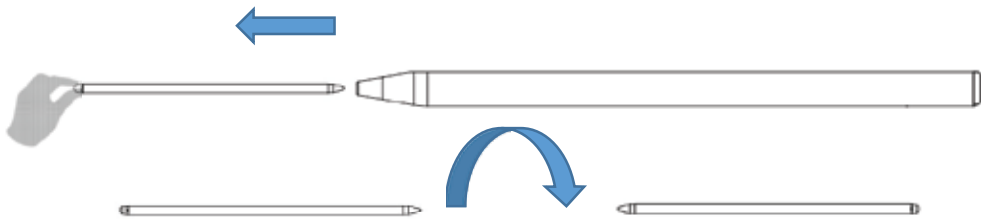

Insert the other nib inside the pen and fix it in place.

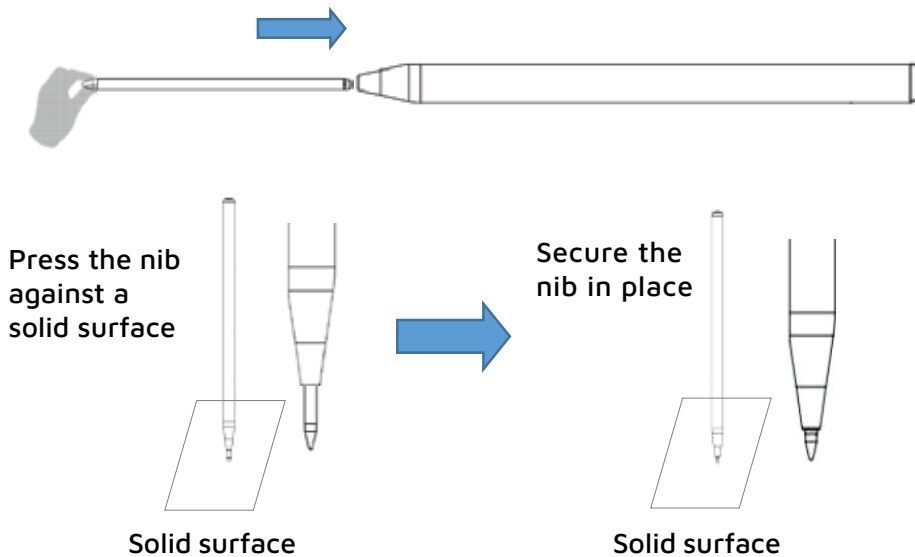

The pen is now equipped with the 'Conventional Ballpoint Pen Nib'.



The steps to switch the pen nib are:

1. Install and use the plastic nib to draw on iPad.

The pen consists of a lithium battery, electronic components (including ICs and passive elements), and a mechanical casing. It remains active and transmits as long as the battery is charged and the pen is powered on, emitting a low-power, low-frequency signal from the nib. To conserve energy, the pen automatically switches off after 5 minutes of inactivity.

Dimensions

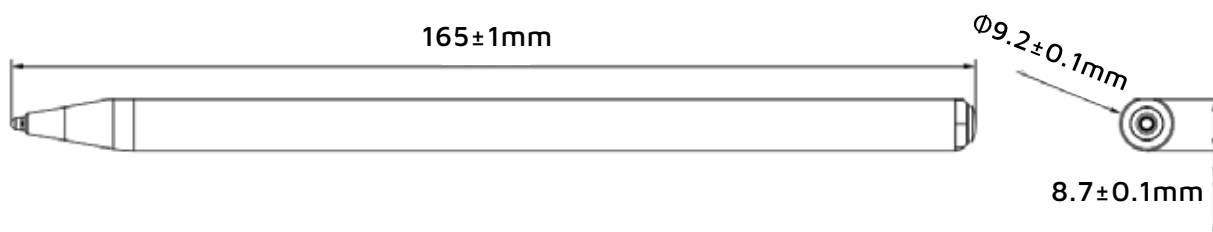

Light Indicator Guide

Function	LED Status	LED Light Color
Device is in Use	ON	Blue
Charging	ON	Red
Low Battery	Blinking	Blue
Charging Completed.	ON	Green
The device is powered while charging.	ON	Red and Blue

Specifications

Product Name	Levelo SkyInk 2 in 1 Stylus Pen & Ballpoint Pen For iPad & Writing
SKU	LVLIS121PBWH
Battery	130mAh Lithium-ion 3.7V
Material	Aluminum Alloy
Charging Interface	Type-C Charging
Charging Time	40 min
Working Time	≥10 hours
Standby Mode	6 Months
Product Size	170×9 mm
Impedance	≤400mΩ
Operating Temperature (Charge)	-10°C to 55°C
Operating Temperature (Discharge)	5°C to 45°C
Environment Temperature/Humidity	5°C to 45°C, 10 % RH to 90 % RH
Storage Temperature/Humidity	-10°C to 35°C, 10 % RH to 90 % RH

Warranty

Products procured directly from the **Levelo** website or physical store comes with a 24-month warranty. **Levelo** products purchased from any of our authorized dealers are guaranteed with a one-year warranty. If you wish to extend this warranty, you'll need to go to our website at <https://levelobrand.com/warranty> and fill out the necessary form, making sure to include your personal information and a photo of the product. After your request has been evaluated and accepted, we'll send you an email notification to affirm the extension of your product's warranty.

For more info, please check:

Website: <https://www.levelobrand.com/warranty>

Contact Us

If you have any questions about this Privacy Policy, please contact us at: Info@levelobrand.com

Website: <https://www.levelobrand.com/>

Email: Info@levelobrand.com

Instagram: [levelobrand](#)

Facebook: [levelobrand](#)